

Lärmschutzwand auf Bauwerk
 Bau-km = 0+360 - 0+450
 Höhe = max. 2,50 m
 Länge = 70 m
 ab Bau-km 0+371,5 Höhe = 1,5 m
 ab Bau-km 0+375,5 Höhe = 2,0 m
 ab Bau-km 0+377,5 Höhe = 2,5 m
 ab Bau-km 0+444,5 Höhe = 2,0 m
 ab Bau-km 0+449,5 Höhe = 1,5 m
 ab Bau-km 0+451,5 Höhe = 1,3 m

Konrad-Adenauer-Brücke
 Bau-km = 0+378,100 bis 0+562,100
 Lichter Höhe > 4,70 m
 Stützweite = 32+44+53+33+20 = 184 m
 Br.z.d. Gel. = 24,77 m

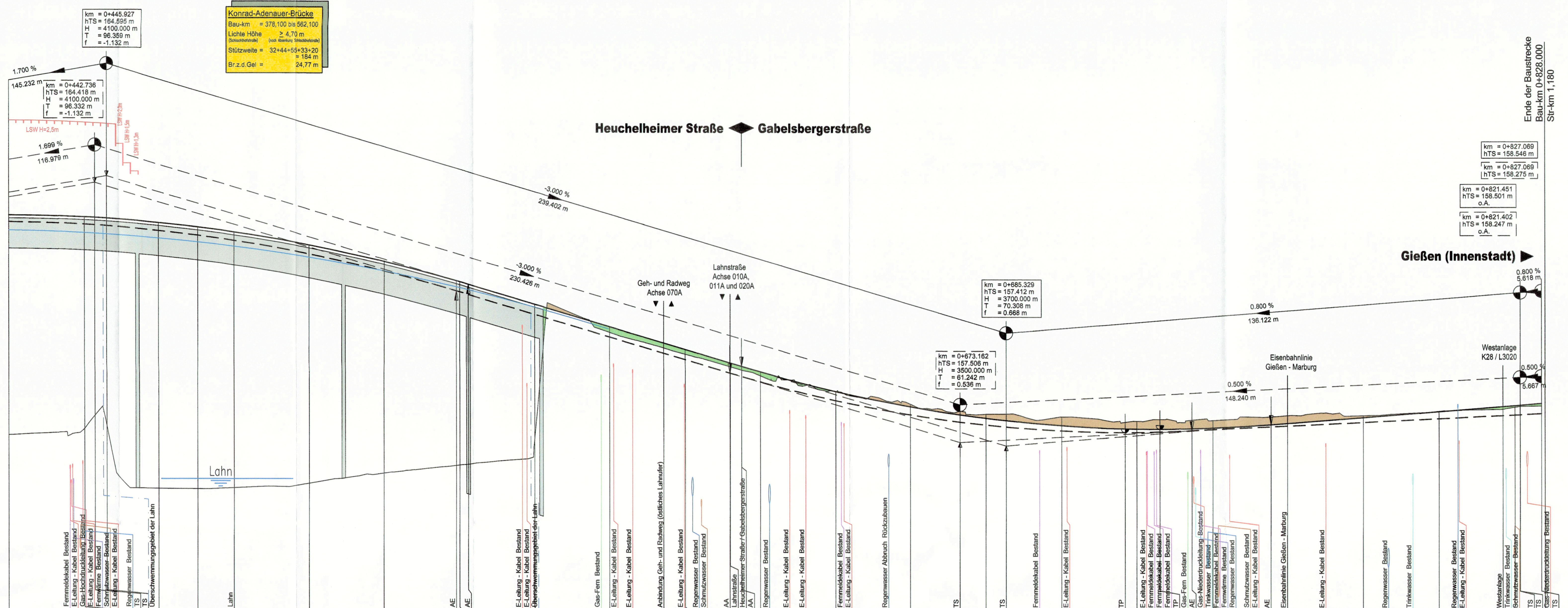

Gradiente der best. Brücke
 Achse 001A
 153,0 m ü.NN

Bauwerk Nr.	Höhe	Gradiente links	Höhe	Gradiente rechts	Geländehöhe	Station	Gradiente
	163,549		163,371	163,549	157,694	400,000	
	163,515		163,324	163,515	157,679	408,000	
	163,514		163,323	163,514	157,684	409,000	
	163,512		163,321	163,512	157,699	410,000	
	163,500		163,310	163,500	157,715	411,000	
	163,500		163,310	163,500	157,725	412,000	
	163,500		163,310	163,500	157,735	413,000	
	163,495		163,305	163,495	157,745	414,000	
	163,495		163,305	163,495	157,755	415,000	
	163,495		163,305	163,495	157,765	416,000	
	163,495		163,305	163,495	157,775	417,000	
	163,495		163,305	163,495	157,785	418,000	
	163,495		163,305	163,495	157,795	419,000	
	163,495		163,305	163,495	157,805	420,000	
	163,495		163,305	163,495	157,815	421,000	
	163,495		163,305	163,495	157,825	422,000	
	163,495		163,305	163,495	157,835	423,000	
	163,495		163,305	163,495	157,845	424,000	
	163,495		163,305	163,495	157,855	425,000	
	163,495		163,305	163,495	157,865	426,000	
	163,495		163,305	163,495	157,875	427,000	
	163,495		163,305	163,495	157,885	428,000	
	163,495		163,305	163,495	157,895	429,000	
	163,495		163,305	163,495	157,905	430,000	
	163,495		163,305	163,495	157,915	431,000	
	163,495		163,305	163,495	157,925	432,000	
	163,495		163,305	163,495	157,935	433,000	
	163,495		163,305	163,495	157,945	434,000	
	163,495		163,305	163,495	157,955	435,000	
	163,495		163,305	163,495	157,965	436,000	
	163,495		163,305	163,495	157,975	437,000	
	163,495		163,305	163,495	157,985	438,000	
	163,495		163,305	163,495	157,995	439,000	
	163,495		163,305	163,495	158,005	440,000	
	163,495		163,305	163,495	158,015	441,000	
	163,495		163,305	163,495	158,025	442,000	
	163,495		163,305	163,495	158,035	443,000	
	163,495		163,305	163,495	158,045	444,000	
	163,495		163,305	163,495	158,055	445,000	
	163,495		163,305	163,495	158,065	446,000	
	163,495		163,305	163,495	158,075	447,000	
	163,495		163,305	163,495	158,085	448,000	
	163,495		163,305	163,495	158,095	449,000	
	163,495		163,305	163,495	158,105	450,000	
	163,495		163,305	163,495	158,115	451,000	
	163,495		163,305	163,495	158,125	452,000	
	163,495		163,305	163,495	158,135	453,000	
	163,495		163,305	163,495	158,145	454,000	
	163,495		163,305	163,495	158,155	455,000	
	163,495		163,305	163,495	158,165	456,000	
	163,495		163,305	163,495	158,175	457,000	
	163,495		163,305	163,495	158,185	458,000	
	163,495		163,305	163,495	158,195	459,000	
	163,495		163,305	163,495	158,205	460,000	
	163,495		163,305	163,495	158,215	461,000	
	163,495		163,305	163,495	158,225	462,000	
	163,495		163,305	163,495	158,235	463,000	
	163,495		163,305	163,495	158,245	464,000	
	163,495		163,305	163,495	158,255	465,000	
	163,495		163,305	163,495	158,265	466,000	
	163,495		163,305	163,495	158,275	467,000	
	163,495		163,305	163,495	158,285	468,000	
	163,495		163,305	163,495	158,295	469,000	
	163,495		163,305	163,495	158,305	470,000	
	163,495		163,305	163,495	158,315	471,000	
	163,495		163,305	163,495	158,325	472,000	
	163,495		163,305	163,495	158,335	473,000	
	163,495		163,305	163,495	158,345	474,000	
	163,495		163,305	163,495	158,355	475,000	
	163,495		163,305	163,495	158,365	476,000	
	163,495		163,305	163,495	158,375	477,000	
	163,495		163,305	163,495	158,385	478,000	
	163,495		163,305	163,495	158,395	479,000	
	163,495		163,305	163,495	158,405	480,000	
	163,495		163,305	163,495	158,415	481,000	
	163,495		163,305	163,495	158,425	482,000	
	163,495		163,305	163,495	158,435	483,000	
	163,495		163,305	163,495	158,445	484,000	
	163,495		163,305	163,495	158,455	485,000	
	163,495		163,305	163,495	158,465	486,000	
	163,495		163,305	163,495	158,475	487,000	
	163,495		163,305	163,495	158,485	488,000	
	163,495		163,305	163,495	158,495	489,000	
	163,495		163,305	163,495	158,505	490,000	
	163,495		163,305	163,495	158,515	491,000	
	163,495		163,305	163,495	158,525	492,000	
	163,495		163,305	163,495	158,535	493,000	
	163,495		163,305	163,495	158,545	494,000	
	163,495		163,305	163,495	158,555	495,000	
	163,495		163,305	163,495	158,565	496,000	
	163,495		163,305	163,495	158,575	497,000	
	163,495		163,305	163,495	158,585	498,000	
	163,495		163,305	163,495	158,595	499,000	
	163,495		163,305	163,495	158,605	500,000	

Krümmung
 Maßstab: 25/R [cm]
 Rechtskurve
 Linkskurve

Querneigung links
 Maßstab: 10%/cm [cm]
 linker Fahrbahnrand
 rechter Fahrbahnrand

Querneigung rechts
 Maßstab: 10%/cm [cm]
 linker Fahrbahnrand
 rechter Fahrbahnrand

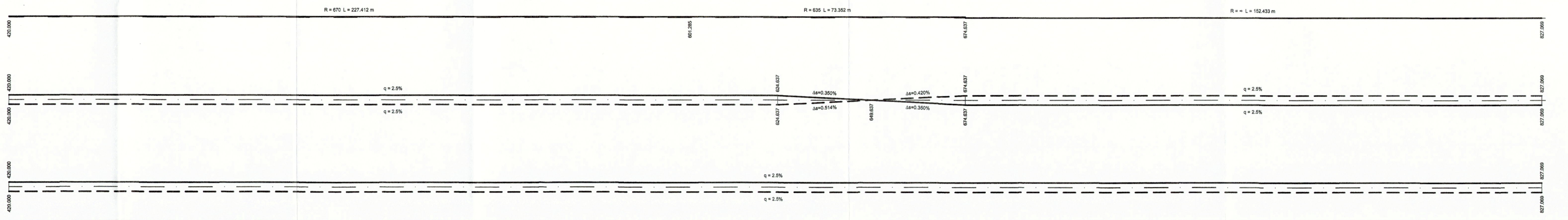

FESTSTELLUNGSENTWURF

Nr.	Art der Änderung	Datum	Name

Entwurfsbearbeitung:
SRP Schneider+Partner
 Ingenieur - Consult GmbH
 Ruppenweg 24
 96317 Kronach
 Am Mühlbach 1
 97475 Zell am Main

Projekt-Nr.: S 07 1031 A
 Datum:
 Zeichner:
 bearbeitet: Januar 2022
 gezeichnet: Januar 2022
 geprüft: 28.01.2022
 dpa

Gießen Der Magistrat
 Tiefbauamt

Erneuerung und Erweiterung der Konrad-Adenauer-Brücke und Grundhafte Erneuerung der L 3020 Heuchelheimer Straße/Gabelsbergerstraße
 Höhenplan Achse 001A - Hauptachse
 Maßstab: 1 : 800/50 Bau-km 0+420 bis Bauende

Aufgestellt: Gießen, den 15.02.2022
 TIEFBAUAMT-88
 L.A. Gaidies (Abt.-Leiter Straßenbau)

Unterlage Nr.: 6
 Blatt Nr.: 2
 Hessen ID: 20630
 Datum:
 Zeichen:

bearbeitet
 gezeichnet
 geprüft

Gießen, den 15.02.2022
 L.A. Reitz (Amtsleiter)
 L.A. Weigel-Grellich (Stadtstr.)